

NOTES:

1. THERMOPLASTIC MUST HAVE HEAT INDICATORS.
2. INSTALLATION OF MARKING/THERMOPLASTIC SHALL NOT REQUIRE PREHEATING OF ASPHALT
3. NO VOC'S (VOLATILE ORGANIC COMPOUNDS).
4. THERMOPLASTIC/MARKING TO BE FREE OF TOXIC CHEMICALS AND METALS.
5. MARKING MUST BE AT LEAST 90 MILS BUT NO MORE THAN 125 MILS (0.125 INCHES) IN THICKNESS.
6. MUST BE APPLIED/INSTALLED WITH A HEAT TORCH.
7. MUST BE RESISTANT TO FUELS, LUBRICANTS, AND DE-ICERS.
8. MUST MEET THE REQUIREMENTS OF THE CURRENT WSDOT ACCEPTED EDITION OF THE MANUAL ON UNIFORM TRAFFIC CONTROL DEVICES (MUTCD).
9. ROAD SURFACE SHALL BE CLEANED BY BLOWER OR BROOM AND COMPLETELY DRY BEFORE APPLICATION.
10. TRANSVERSE MARKINGS SHALL BE PLACED AT THE CENTER OF TRAVEL LANE.

SPEED (MPH)	25	30	35	40	45	50
D* (feet)	250	300	350	400	450	500



## TRANSVERSE MARKINGS STOP AHEAD LEGEND

APPROVED BY: *Matthew*  
 COUNTY ENGINEER

10/27/2025  
 DATE

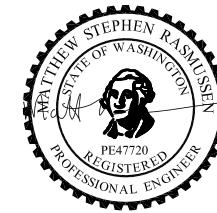

STANDARD PLAN

R-8

SHEET 1 OF 6

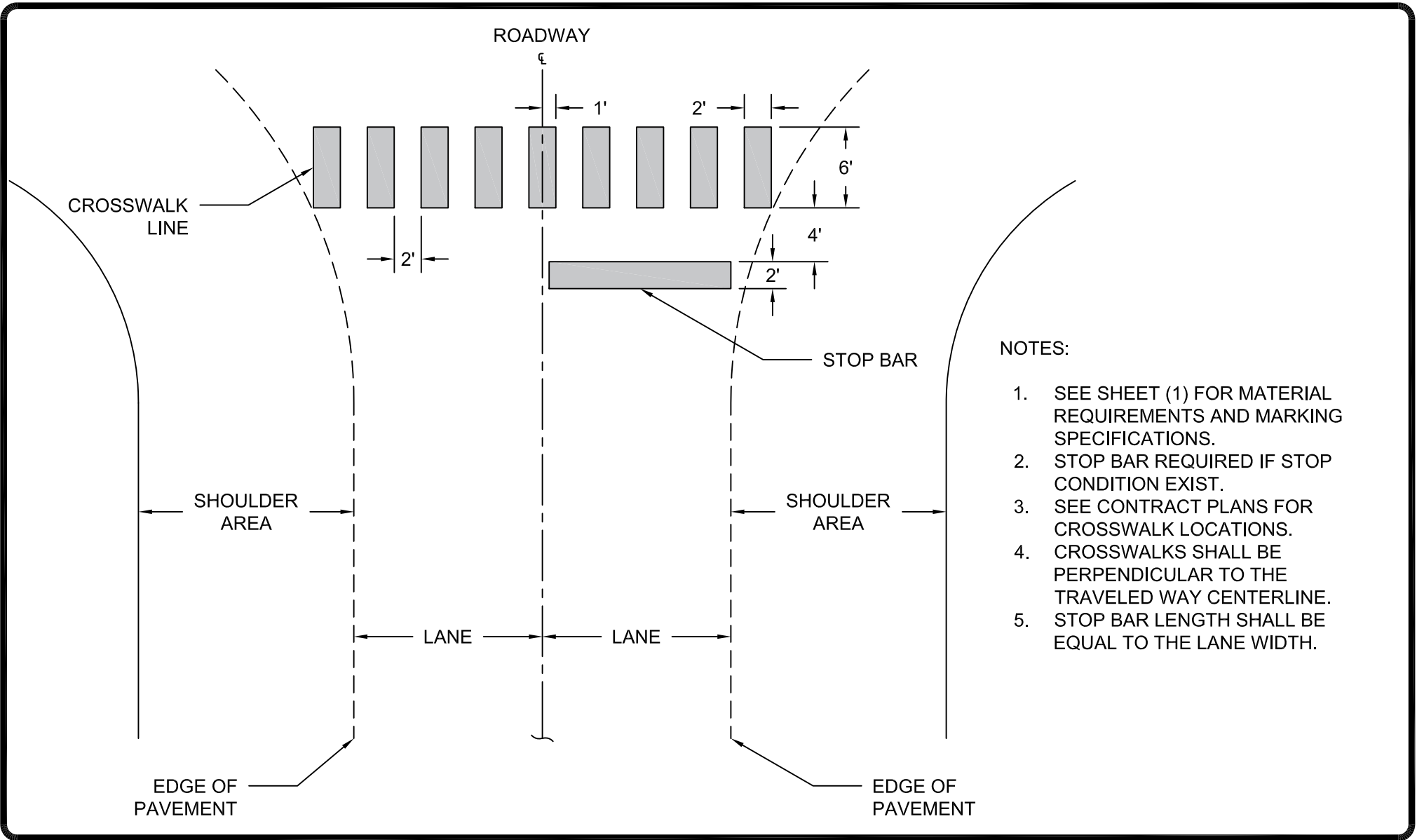

NOTES:

1. SEE SHEET (1) FOR MATERIAL REQUIREMENTS AND MARKING SPECIFICATIONS.
2. STOP BAR REQUIRED IF STOP CONDITION EXIST.
3. SEE CONTRACT PLANS FOR CROSSWALK LOCATIONS.
4. CROSSWALKS SHALL BE PERPENDICULAR TO THE TRAVELED WAY CENTERLINE.
5. STOP BAR LENGTH SHALL BE EQUAL TO THE LANE WIDTH.



# TRANSVERSE MARKINGS INTERSECTION CROSSWALK

APPROVED BY:  
  
 COUNTY ENGINEER

10/27/2025  
 DATE

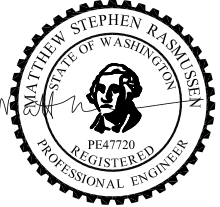

STANDARD PLAN

## R-8

SHEET 2 OF 6

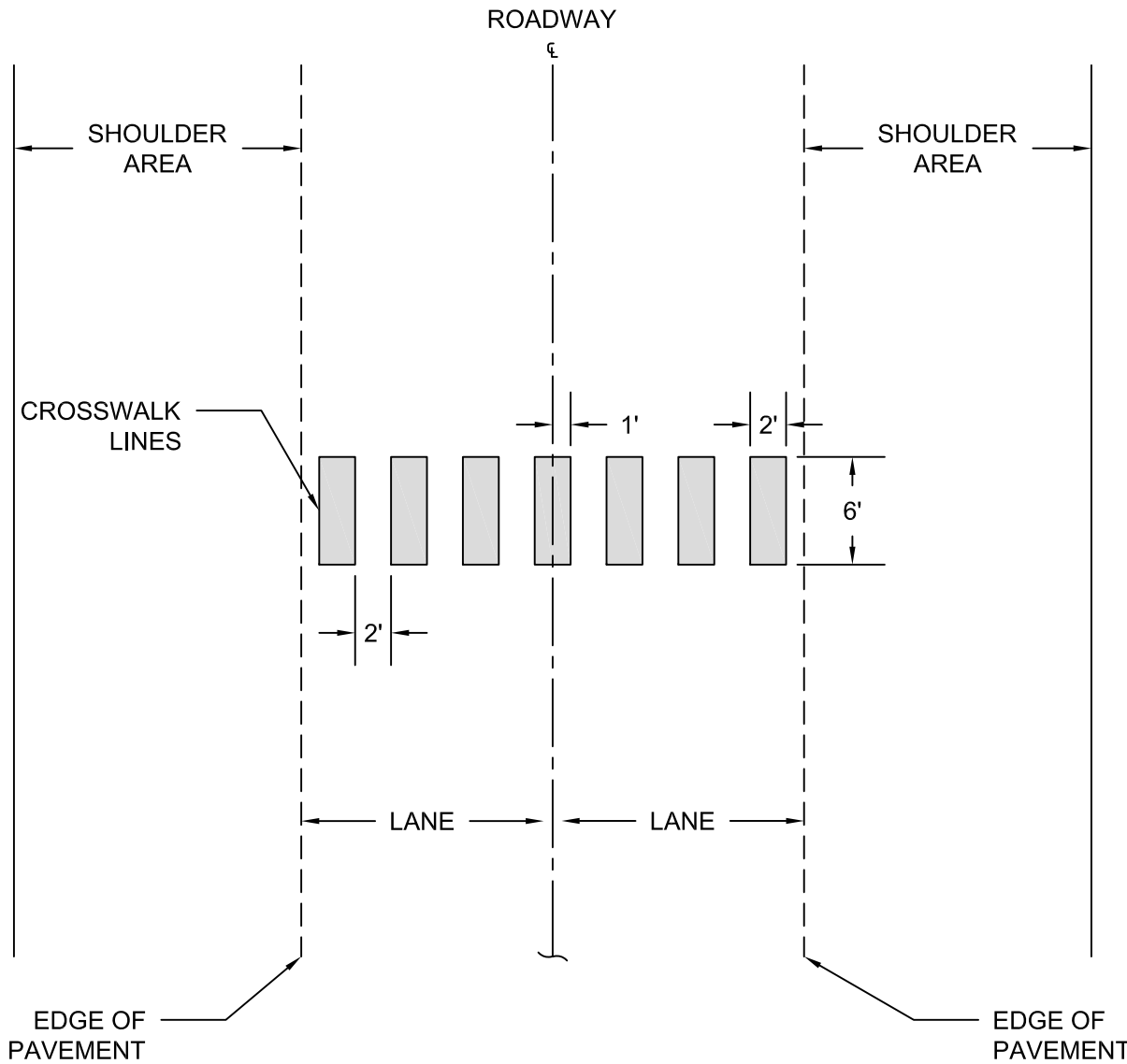

NOTES:

1. SEE SHEET (1) FOR MATERIAL REQUIREMENTS AND MARKING SPECIFICATIONS.
2. FOLLOW THE CURRENT WSDOT ACCEPTED VERSION OF THE MANUAL ON TRAFFIC CONTROL DEVICES (MUTCD) FOR SIGN PLACEMENT.
3. SEE CONTRACT PLANS FOR CROSSWALK LOCATIONS.
4. CROSSWALKS SHALL BE PERPENDICULAR TO THE TRAVELED WAY CENTERLINE.



## TRANSVERSE MARKINGS MID-BLOCK CROSSWALK

APPROVED BY:

*Matthew*  
COUNTY ENGINEER

10/27/2025

DATE



STANDARD PLAN

R-8

SHEET 3 OF 6

SYMBOL & LANE

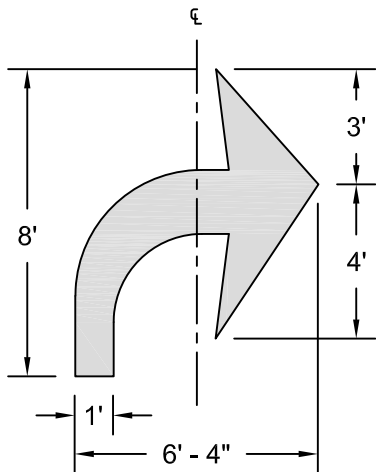

RIGHT ARROW

SYMBOL & LANE

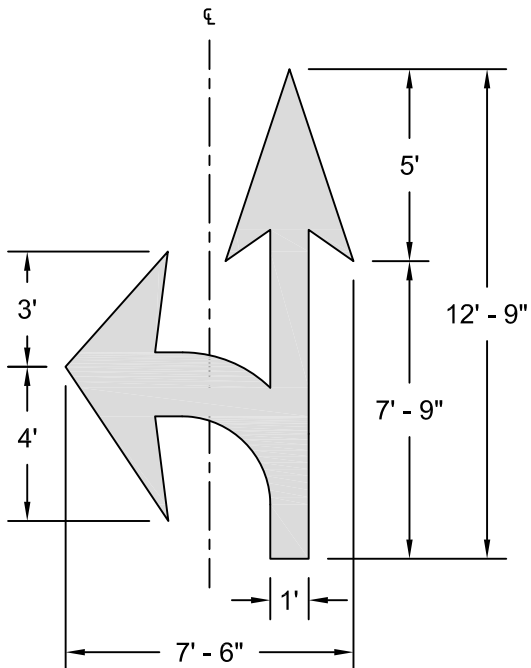

LEFT COMBINATION ARROW

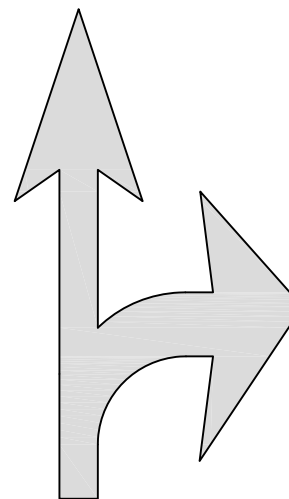

RIGHT COMBINATION ARROW  
(MIRROR IMAGE OF  
LEFT COMBINATION ARROW)

SYMBOL & LANE

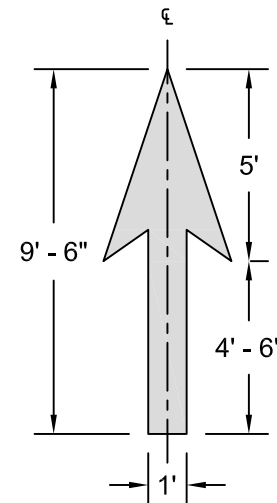

STRAIGHT ARROW

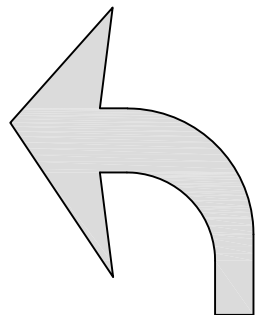

LEFT ARROW  
(MIRROR IMAGE OF  
RIGHT ARROW)

NOTES:

1. SEE SHEET (1) FOR MATERIAL REQUIREMENTS AND PREMARK SPECIFICATIONS.
2. SEE CONTRACT PLANS FOR LOCATION.
3. TRANSVERSE MARKINGS SHALL BE PLACED AT THE CENTER OF TRAVEL LANE.



TRANSVERSE MARKINGS  
TRAFFIC ARROWS

APPROVED BY:  
*Matthew*  
COUNTY ENGINEER

10/27/2025  
DATE



STANDARD PLAN

R-8

SHEET 4 OF 6

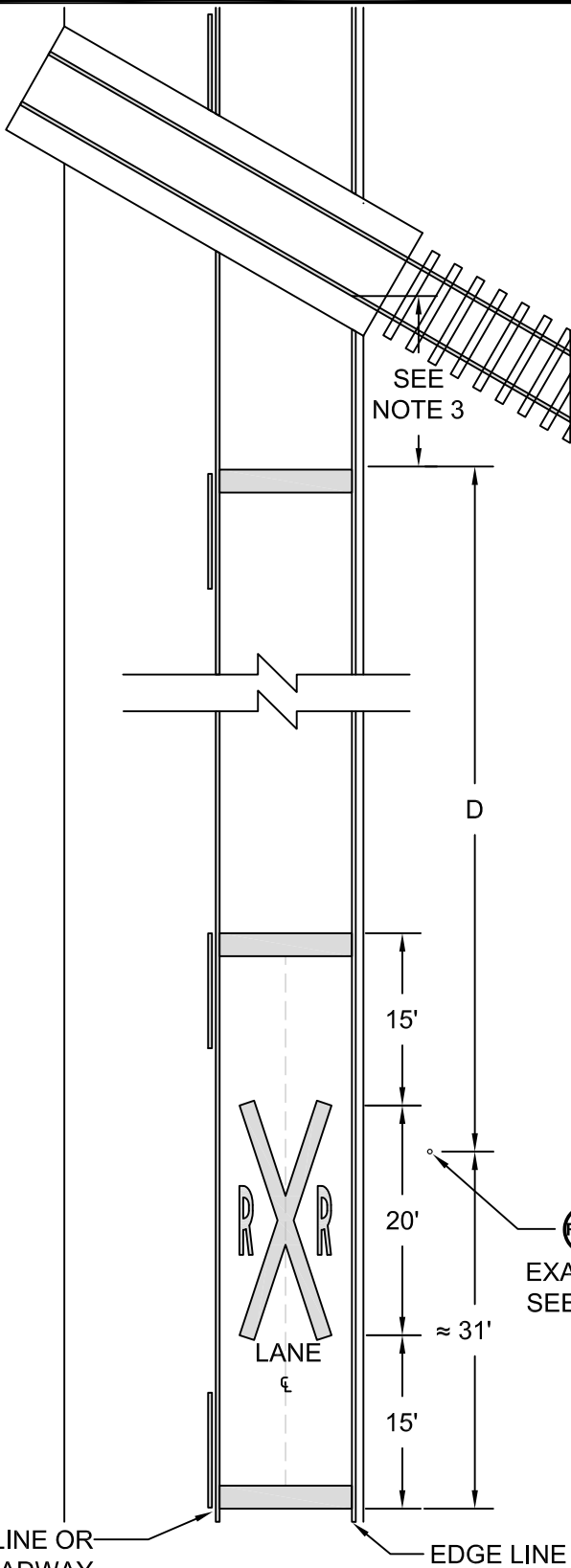

NOTES:

1. SEE SHEET (1) FOR MATERIAL REQUIREMENTS AND MARKING SPECIFICATIONS.
2. STOP BAR WIDTH 24" WHITE TRANSVERSE LINE.
3. PLACE STOP BAR BETWEEN 15' - 50' FROM NEAREST RAIL. IF GATE IS PRESENT PLACE STOP LINE APPROXIMATELY 8' FROM RR GATE.
4. FOLLOW THE CURRENT WSDOT ACCEPTED VERSION OF THE MANUAL ON TRAFFIC CONTROL DEVICES (MUTCD) FOR RAILROAD SIGN PLACEMENT.

MPH	D*
25	250Ft.
30	300Ft.
35	350Ft.
40	400Ft.
45	450Ft.
50	500Ft.

CENTER LINE OR  
ROADWAY  
CENTERLINE

EDGE LINE

EXAMPLE ONLY  
SEE NOTE 4

TRANSVERSE MARKINGS  
RAILROAD CROSSING



APPROVED BY:  
*Matthew*  
COUNTY ENGINEER

10/27/2025  
DATE



STANDARD PLAN

R-8

SHEET 5 OF 6

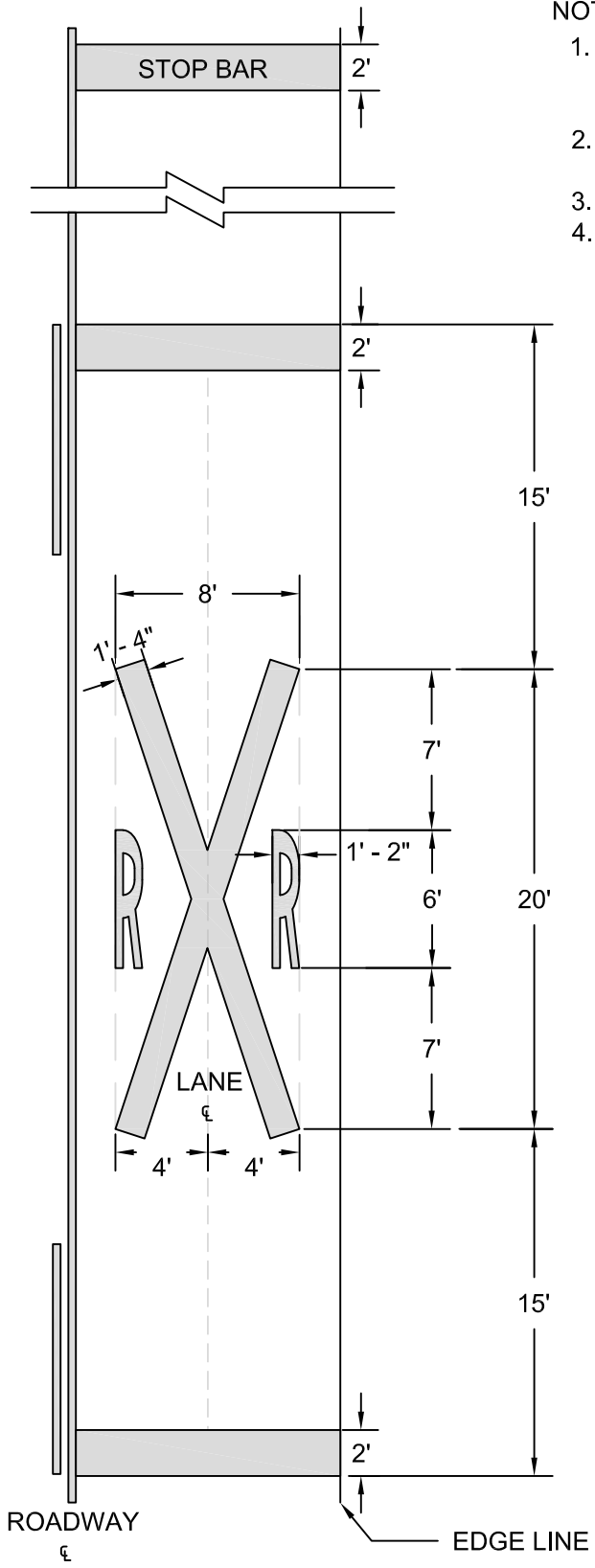

NOTES:

1. SEE SHEET (1) FOR MATERIAL REQUIREMENTS AND MARKING SPECIFICATIONS.
2. WHITE TRANSVERSE LINES ARE 24" WIDE.
3. STOP BAR 24" WIDE
4. LENGTH OF TRANSVERSE LINES MAY VARY ACCORDING TO LANE WIDTH.



TRANSVERSE MARKINGS  
RAILROAD CROSSING

APPROVED BY:  
*Matthew Rasmussen*  
COUNTY ENGINEER

10/27/2025  
DATE



STANDARD PLAN

R-8

SHEET 6 OF 6